

ORDINANCE NO. 2619

AN ORDINANCE OF THE CITY OF REDLANDS AMENDING CHAPTER 18 OF THE REDLANDS MUNICIPAL CODE BY ADOPTING A REVISED LAND USE ZONING MAP AND PREZONING CERTAIN PROPERTY LOCATED IN THE UNINCORPORATED AREA OF THE COUNTY OF SAN BERNARDINO

ZONE CHANGE NO. 414

THE CITY COUNCIL OF THE CITY OF REDLANDS DOES ORDAIN AS FOLLOWS:

Section 1. The zoning designation for 6.73 acres identified as Assessor Parcel No. 297-121-07 located on the northeast corner of Wabash Avenue and San Bernardino Avenue is hereby changed from unincorporated San Bernardino County I-C (Community-Industrial) District to the City of Redlands' M-1 (Light Industrial) District, and the zoning designation for the remaining 8.90 acres identified as Assessor Parcel Nos. 0297-121-10 and 11 is hereby changed from unincorporated San Bernardino County AG-AP (Agricultural/Agricultural Preserve) District to the City of Redlands' C-M (Commercial Industrial) District.

Section 2. Pursuant to Government Code section 65859, the new zoning prescribed by this ordinance shall take effect at the time annexation of Assessor Parcel Nos. 0297-121-07, 0297-121-10 and 11 to the City of Redlands becomes effective.

Section 3. The Mayor shall sign this ordinance and the City Clerk shall certify to the adoption of this ordinance and shall cause it, or a summary of it, to be published once in the Redlands Daily Facts, a newspaper of general circulation within the City, and thereafter, this ordinance shall take effect in accordance with law.



Mayor of the City of Redlands

ATTEST:



City Clerk

I, Lorrie Poyzer, City Clerk of the City of Redlands, hereby certify that the foregoing ordinance was duly adopted by the City Council at a regular meeting thereof held on the 20th day of September, 2005.

AYES: Councilmembers Gil, Gilbreath, George, Harrison; Mayor Pepler
NOES: None
ABSENT: None
ABSTAINED: None



City Clerk

ZONE CHANGE MAP

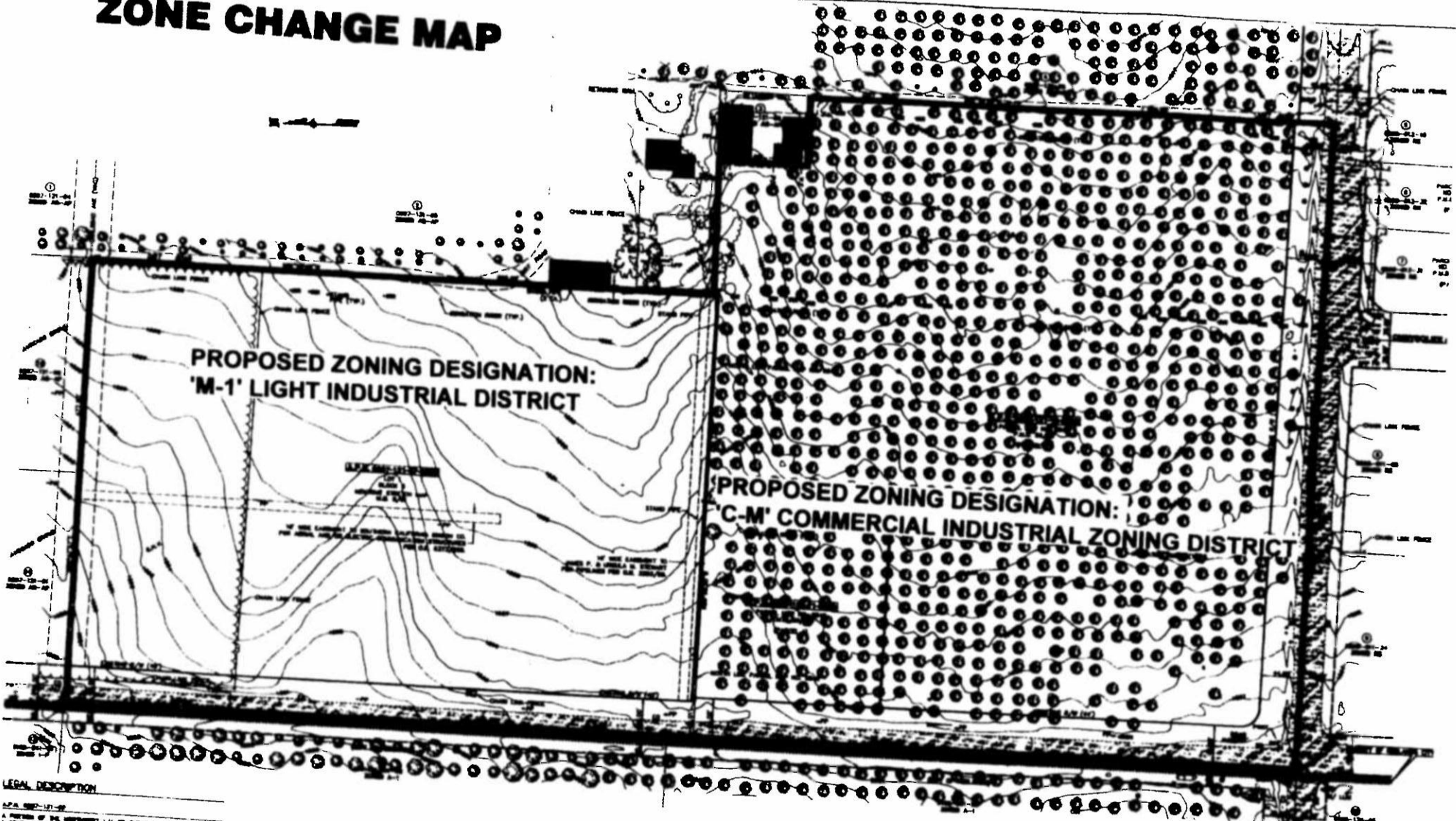

**PROPOSED ZONING DESIGNATION:
'M-1' LIGHT INDUSTRIAL DISTRICT**

**PROPOSED ZONING DESIGNATION:
'C-M' COMMERCIAL INDUSTRIAL ZONING DISTRICT**

LEGAL DESCRIPTION

APN 002-141-02
A PORTION OF THE UNIMPOSED 1/4 OF THE SOUTHWEST 1/4 SECTION 18, TOWNSHIP 2 NORTH, RANGE 7 WEST, SHERMAN COUNTY, CALIFORNIA, AS SHOWN ON THE ATTACHED MAP AS FOLLOWS:
COMMENCED AT A POINT IN THE E 1/4 OF SECTION 18, TOWNSHIP 2 NORTH, RANGE 7 WEST, SHERMAN COUNTY, CALIFORNIA, AND THENCE S89°15'12\"

APN 002-141-04
PARCELS 1 AND 2 OF FRAME 101 AND 102 AS FOR PLAT 115801 IN BOOK 40 OF PUBLIC MAPS, SHERMAN COUNTY OF THE COUNTY OF SHERMAN, STATE OF CALIFORNIA, AND THE PORTION OF THE COUNTY OF SHERMAN, STATE OF CALIFORNIA, AS SHOWN ON THE ATTACHED MAP AS FOLLOWS:
COMMENCED AT A POINT IN THE E 1/4 OF SECTION 18, TOWNSHIP 2 NORTH, RANGE 7 WEST, SHERMAN COUNTY, CALIFORNIA, AND THENCE S89°15'12\"

INDEX MAP

